

## Programming instruction

The lock automatically recognizes the programming card and the data carrier included in the scope of delivery. However, programming can be changed at any time, as described in the following.

### Programming of the card

Press the programming key (1) of the lock for three seconds until you hear a long acoustic signal followed by a ticking lasting for approx. 7 seconds. During the ticking signal hold the programming card (8) to the identification zone (3) until you hear an acoustic signal of recognition. Now the card is programmed.

### Programming of the data carrier

Hold the programming card (8) once to the identification zone (3). A ticking lasting for 7 seconds is to be heard. During the ticking hold the data carrier (7) to the identification zone (3) for read-in until you hear an acoustic signal of recognition. Now the data carrier is programmed.

### Control the data carrier as to its functioning

Hold the data carrier (7) to the identification zone (3) until you hear an acoustic recognition signal and until the spring advances. Hold the data carrier (7) once again to the identification zone (3) until you hear an acoustic recognition signal and the opening interval is started.

### Delete individual programmed data carriers

Hold the programming card (8) once to the identification zone (3) until you hear a ticking lasting for approx. 7 seconds. Hold the data carrier (7) for deletion to the identification area during the ticking until hear a recognition signal. Now the data carrier is deleted.

### Delete all programmed data carriers

Hold the programming card (8) to the identification zone (3) until you hear four short acoustic signals followed by a long recognition signal. Now all the programmed data carriers are deleted and the spring has returned into opening position.

### Activate or deactivate the acoustic signal

Push the programming key (1) for one second.

**All settings, for which the programming key (1) is not needed, can be made with the lock already mounted. The electronics of the lock is able to read the data carrier and the programming card even through materials of up to 20 mm thickness.**

**Warning:** The correct functioning can only be guaranteed if the lock is mounted on non-conduction materials (wood, synthetic material) with a max. thickness of 20mm. In case of a higher thickness, with metal doors or doors with a metal application, an antenna has to be installed.

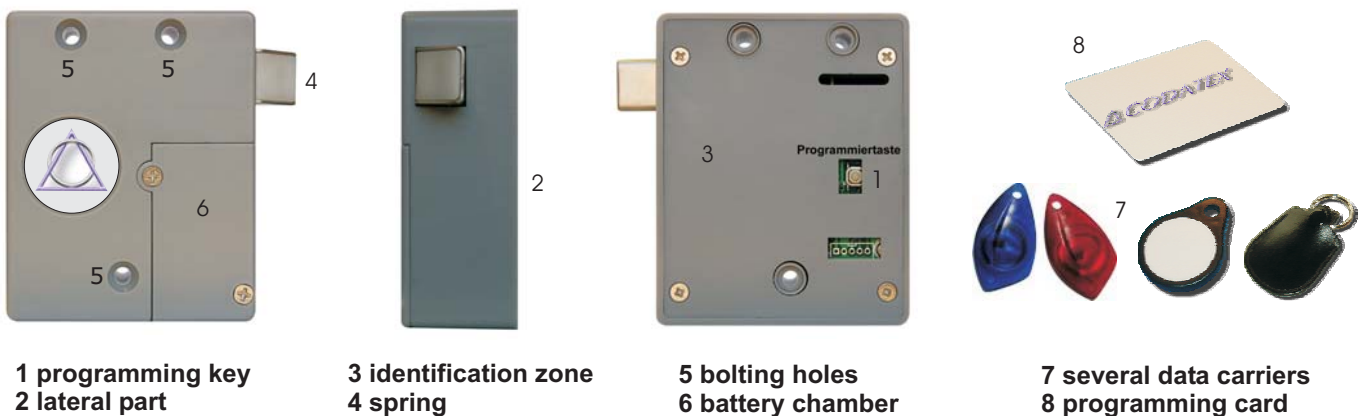

### Battery removal

Open the battery chamber (6), remove the used battery and in order to avoid a malfunction, wait approx. **30 seconds** before inserting the new battery. Take care of the polarity (+/-) as indicated at the bottom of the battery chamber and on the battery.

**The integrated lithium cell 3V has a useful life of 20.000 openings. Before the cell is used, an acoustic signal indicates that the cell should be replaced. If this signal goes unheard, the lock is opened with the residual power and remains opened until the cell is replaced.**